

CONTRACTORS SHALL VERIFY JOB DIMENSIONS BEFORE ANY JOB COMMENCES. ALL SHOP DRAWINGS SHALL BE SUBMITTED TO THE SUPERINTENDENT AND MANUFACTURERS SHALL NOT COME FROM THE REPLY OF DRAWINGS SHOWN. BY THE CONSULTANT FOUR-DIGIT DIMENSIONS SHALL TAKE PRECEDENCE OVER SCALED. THIS DRAWING SHOULD BE READ IN CONJUNCTION WITH ALL RELEVANT CONTRACT SPECIFICATIONS AND DRAWINGS COPYRIGHT OF THIS DRAWING IS VESTED IN WARDLE

- General Notes
- CL-XX CEILING SYSTEM. REFER TO MATERIALS SCHEDULE
  - CH CEILING HEIGHT
  - FF-XX POWDERCOAT FINISH. REFER TO MATERIALS SCHEDULE
  - PA-XX PAINT FINISH. REFER TO MATERIALS SCHEDULE

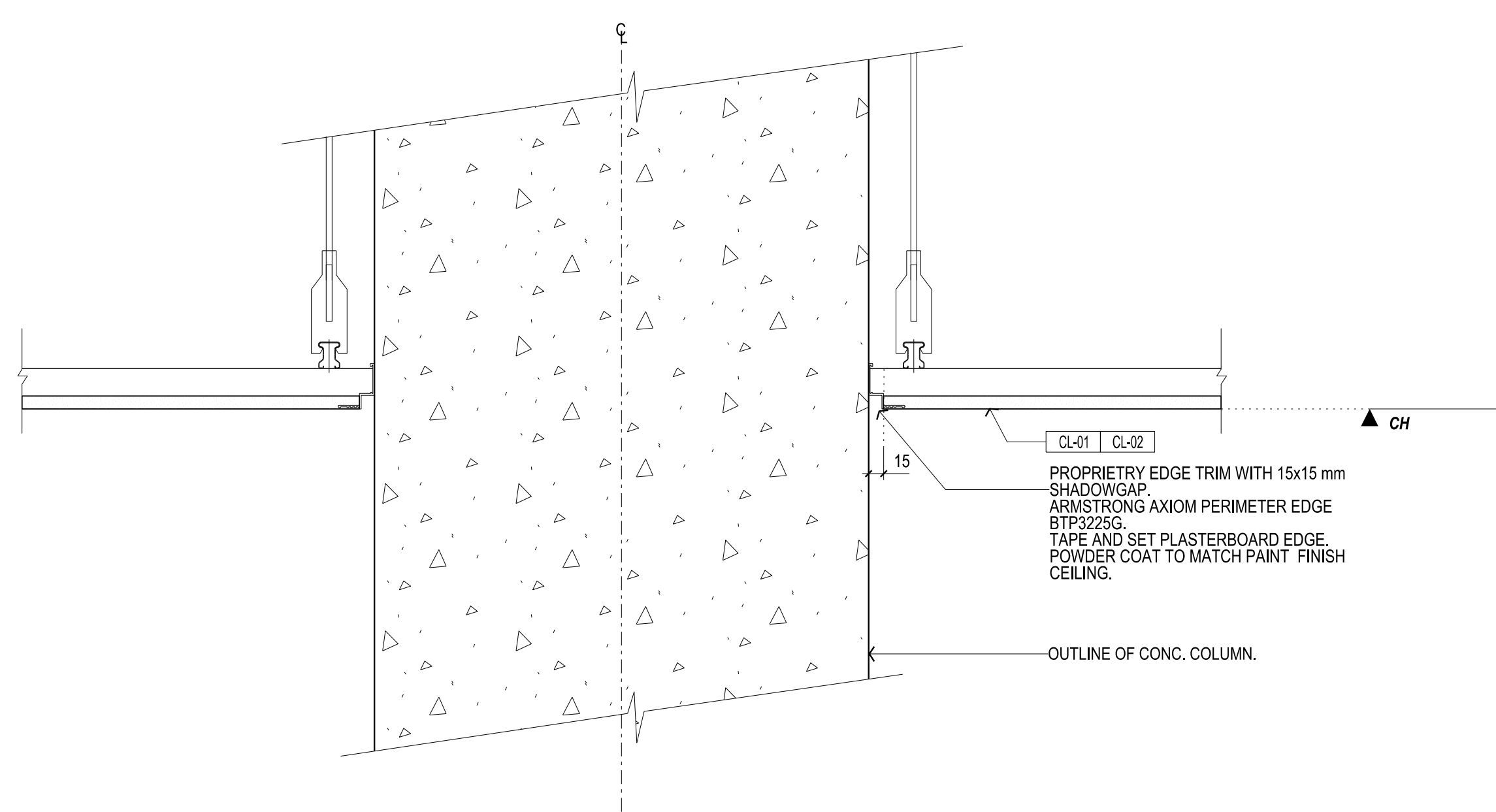

01  
2002  
PLASTERBOARD CEILING TO CONCRETE COLUMN-TYPICAL SECTION DETAIL  
SCALE 1:5

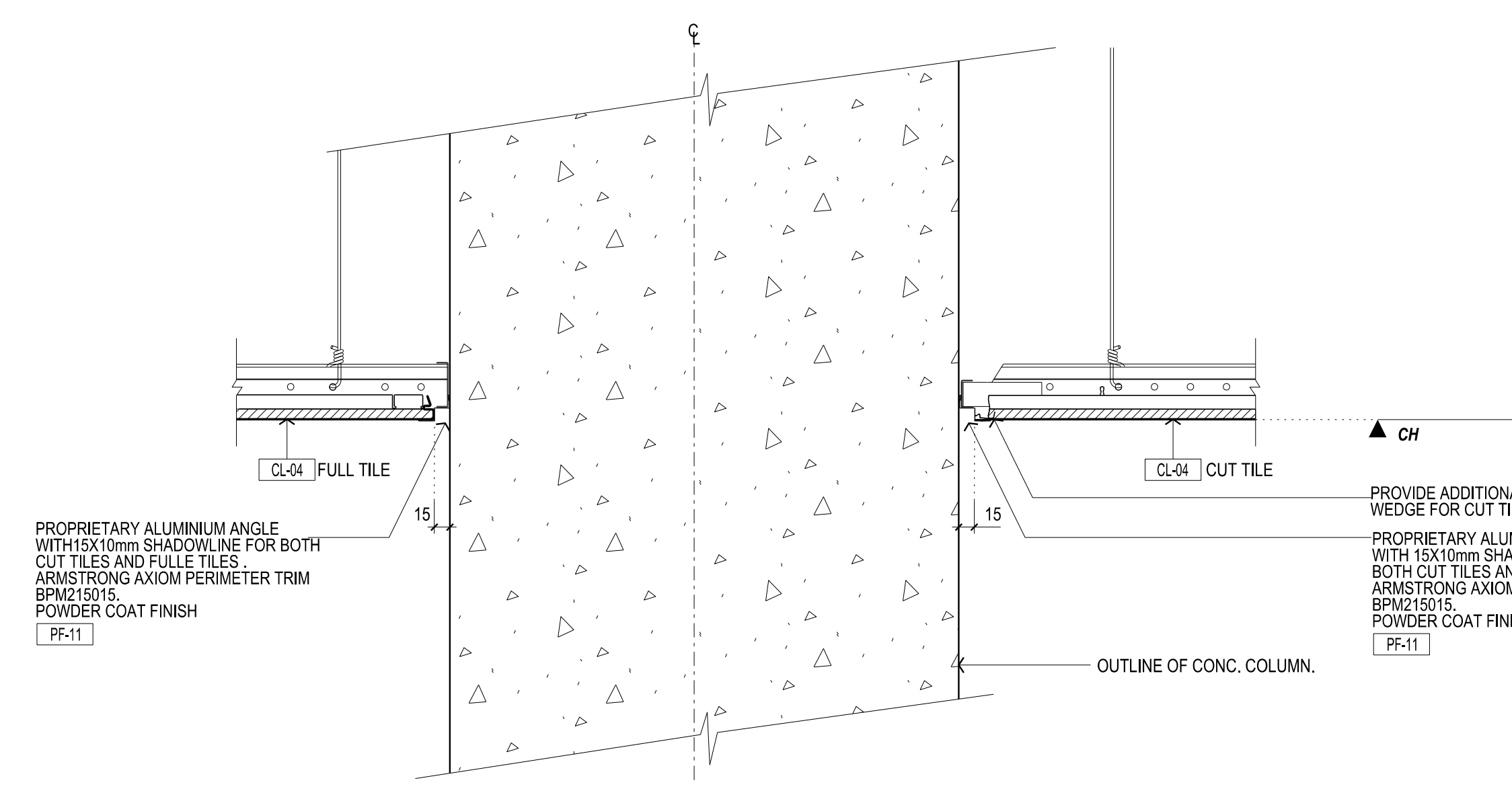

02  
2002  
METAL PAN CEILING TILE TO COLUMN JUNCTION -TYPICAL SECTION DETAIL  
SCALE 1:5

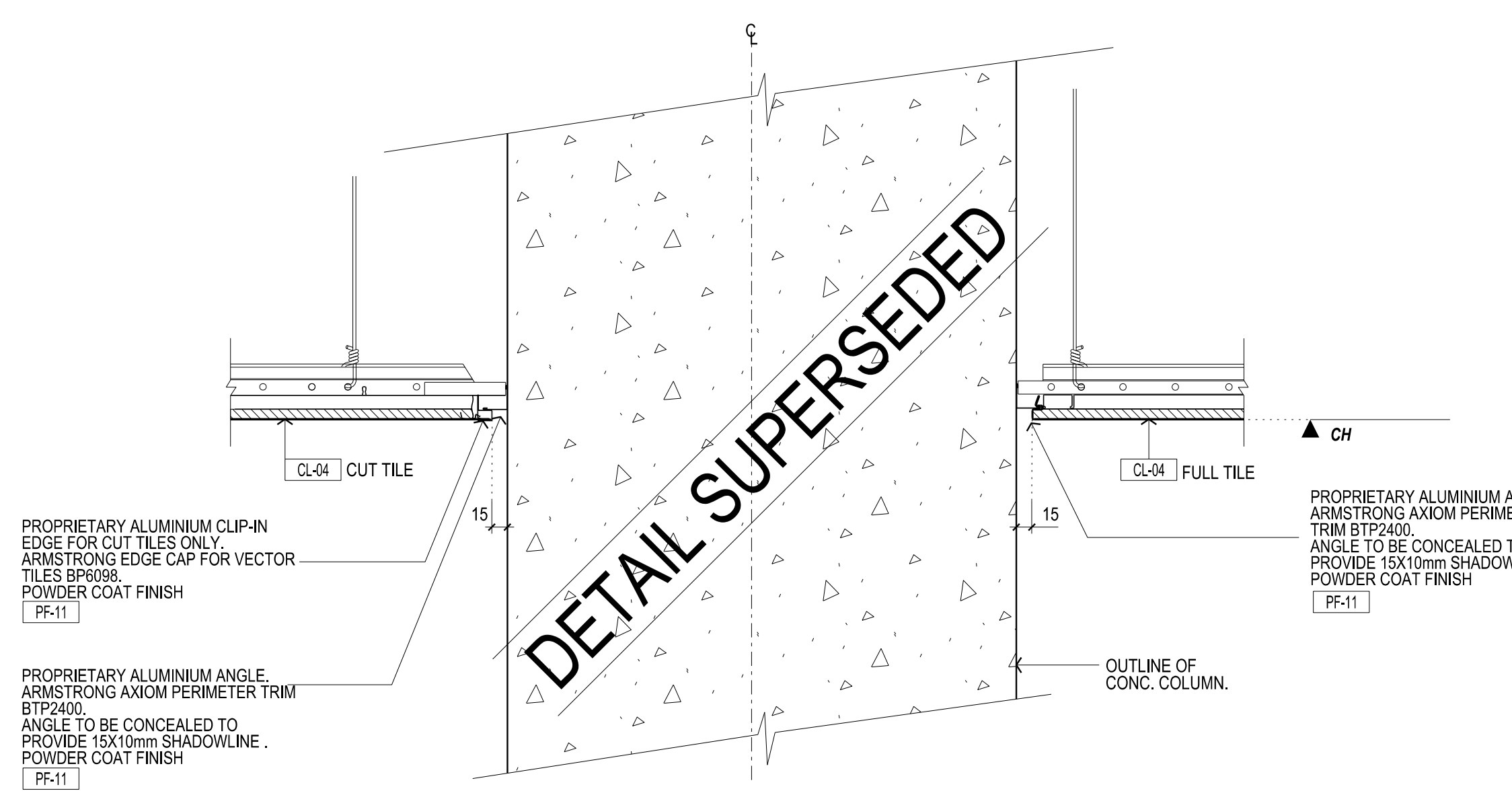

03  
2002  
METAL PAN CEILING TILE TO COLUMN JUNCTION -DEAN'S AREA ONLY SECTION DETAIL  
SCALE 1:5

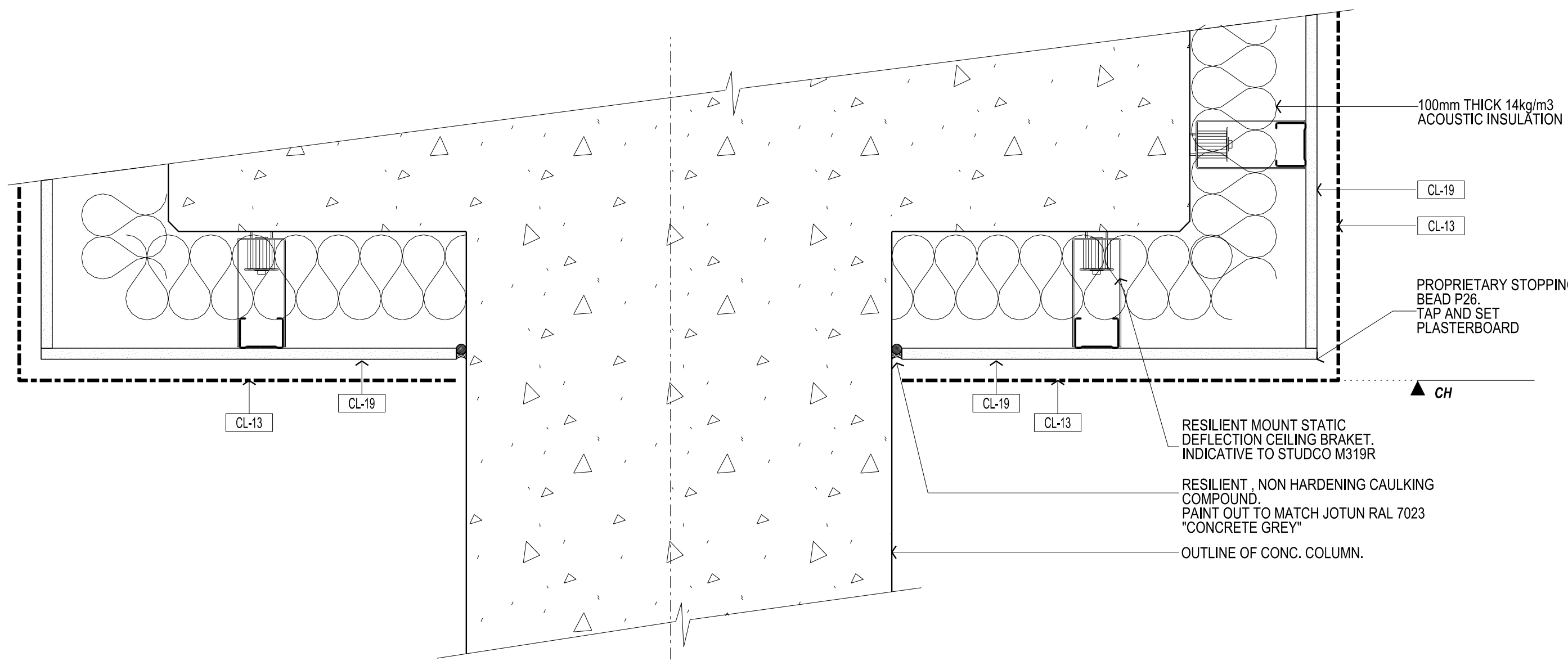

04  
2002  
ACOUSTIC PLASTERBOARD CEILING TO CONCRETE COLUMN SECTION DETAIL  
SCALE 1:5

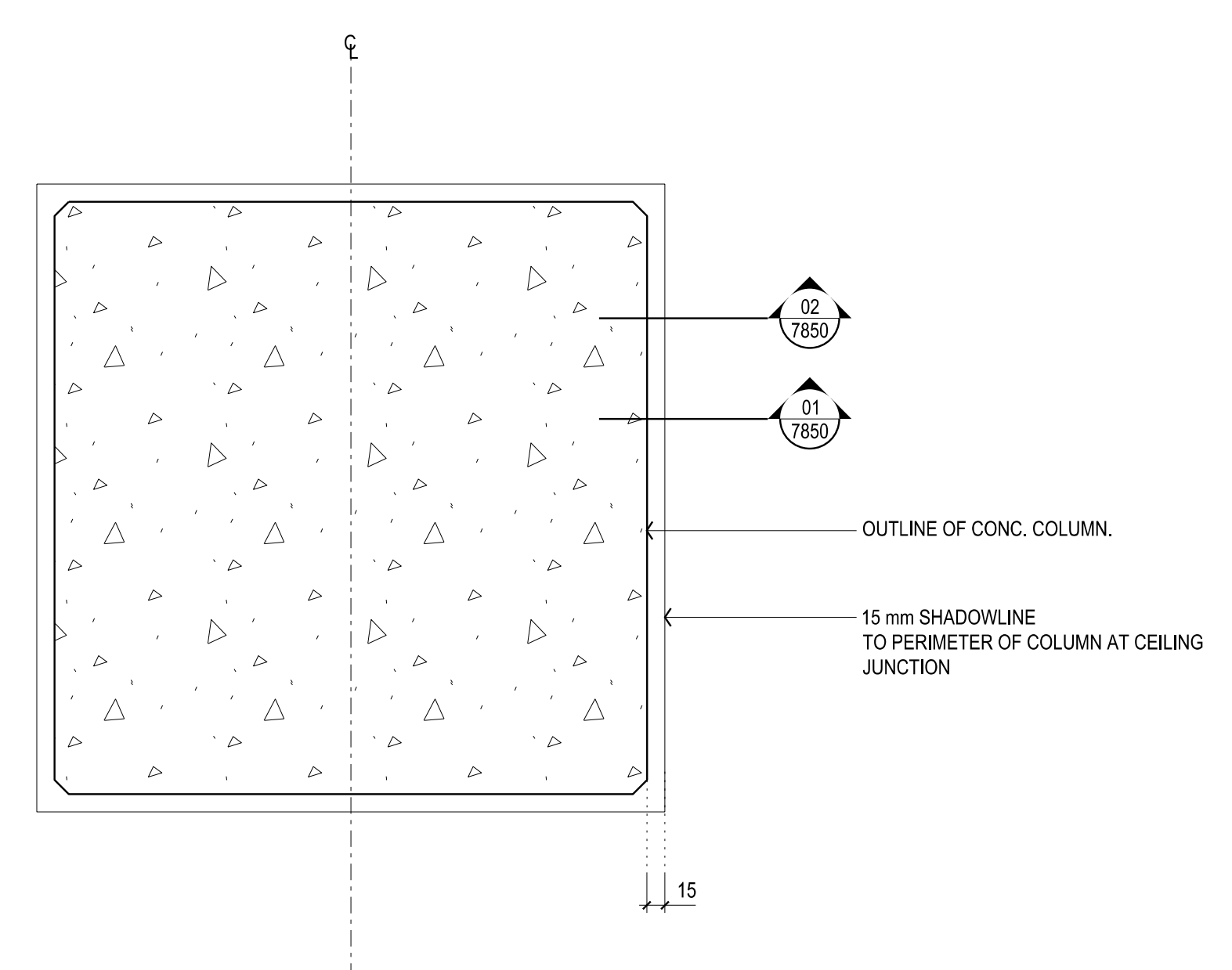

05  
2002  
PLASTERBOARD CEILING /METAL PAN CEILING TO CONCRETE COLUMN PLAN DETAIL  
SCALE 1:5

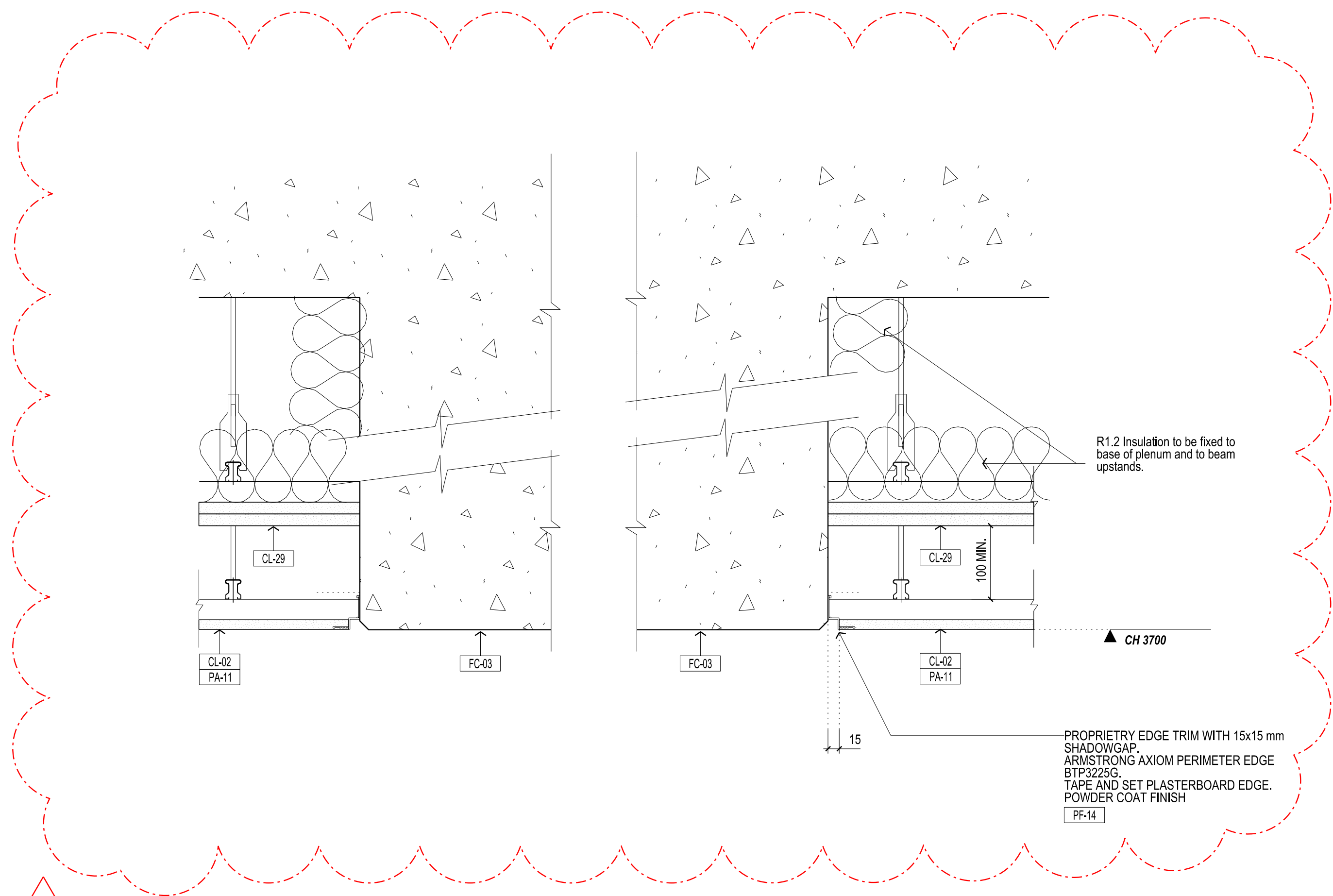

06  
2002  
PLASTERBOARD CEILING TO CONCRETE BEAM JUNCTION SECTION DETAIL  
SCALE 1:5

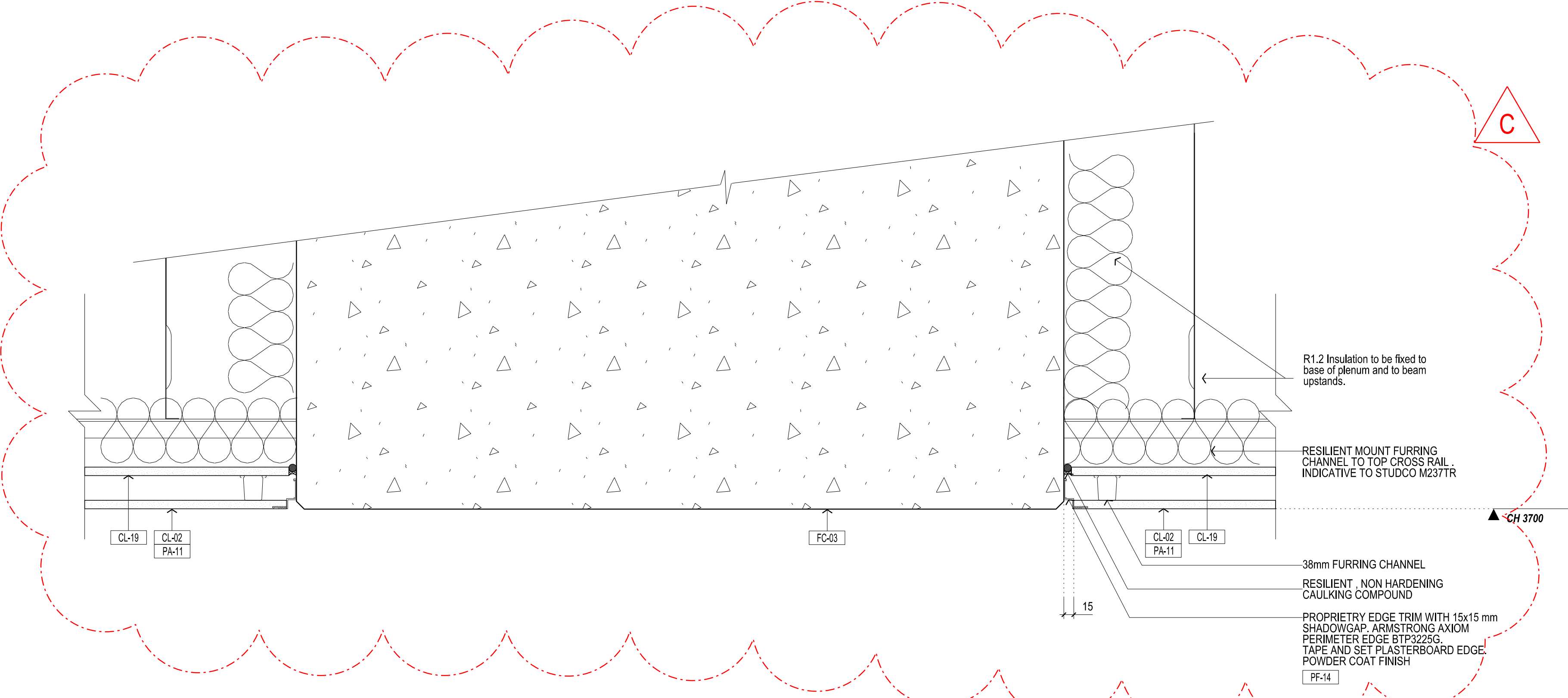

07  
2002  
PLASTERBOARD CEILING WITH ACOUSTIC PLASTERBOARD ABOVE TO CONCRETE BEAM JUNCTION SECTION DETAIL  
SCALE 1:5

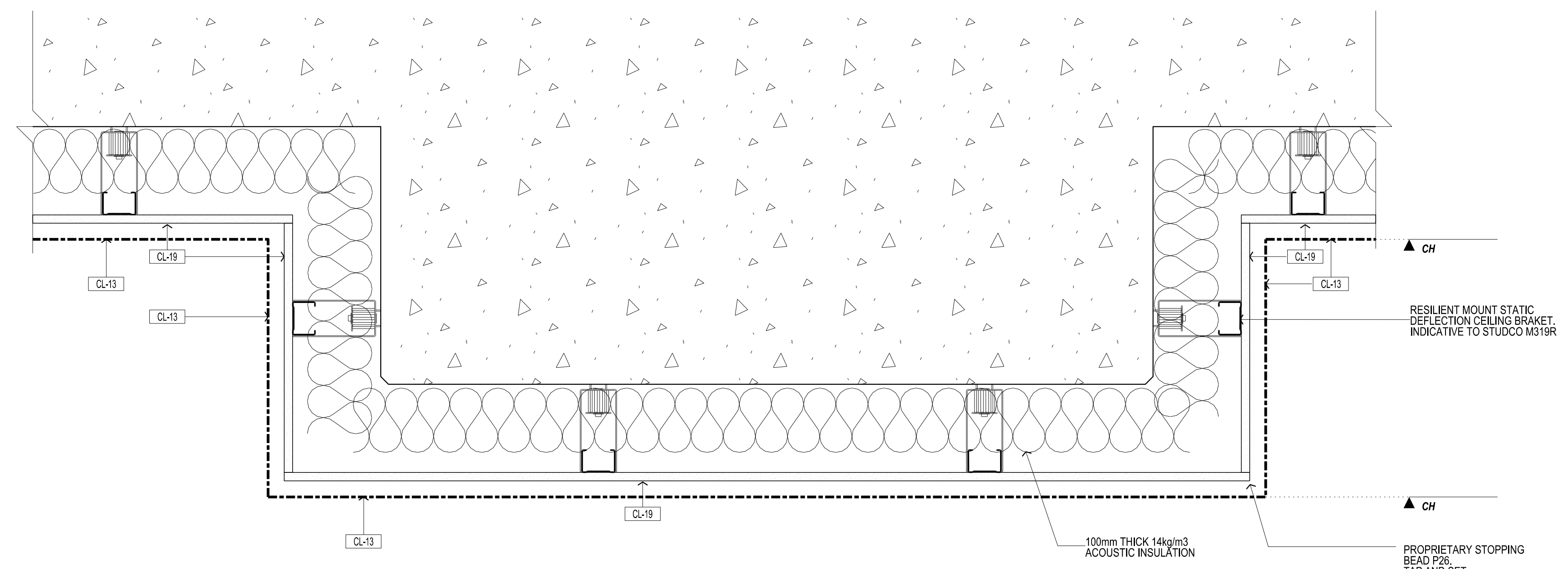

08  
2002  
ACOUSTIC PLASTERBOARD CEILING TO CONCRETE BEAM SECTION DETAIL  
SCALE 1:5

- NOTES
1. REFER TO 2000 SERIES DWGS FOR CEILING PLANS FINISHES & SETOUT
  2. REFER TO SERVICES CONSULTANTS DOCUMENTATION FOR SPECIFICATION OF FIXTURES & FITTINGS BELOW
  3. ENSURE ALL EMERGENCY LIGHT SMOKE DETECTOR LIGHT FITTING WIRES ARE RETICULATED TO SLAB. ALL WIRING TO BE SPREAD OR PRE-COLOURED TO MATCH ADJACENT CEILING. REFER TO MATERIALS SCHEDULE FOR DETAILS.
  4. ALL SERVICES TO BE POWDERCOATED OR PAINTED ON SITE TO MATCH CEILING COLOUR. REFER TO MATERIALS SCHEDULE FOR EXACT SPECIFICATION.
  5. TO BE READ IN CONJUNCTION WITH A2020 CEILING PLANS AND WITH A2010 PACKAGE DETAILS AND ARTWORK WALL TYPES DRAWINGS

Rev	Issue	Revision Description	And	Date
C	SG	DETAILS UPDATED AS CLOUDED	-	25.11.13
B	SG	PLASTERBOARD PACKAGE UPDATE DETAILS UPDATED AS CLOUDED	-	19.08.13
A	SG	CROSS REFERENCING TO DETAILS ADDED	-	17.09.12
03	SG	100% CD - TENDER ISSUE	-	07.09.12
02	SG	90% CD ISSUE	-	10.08.12
01	SG	75% CD ISSUE	-	13.07.12



**NADAAA**  
 NADAAA  
 1020 Washington Street No.2 Boston Massachusetts 02118 USA  
 Telephone +1 817 442 8232 Facsimile +1 888 442 1417 Email nad@nadaaa.com

**John Wardle Architects**  
 25 Rokeby Street, Collingwood, Victoria 3066 Australia  
 Tel: +61 3 8662 0400 www.johnwardlearchitects.com  
 © 2012 John Wardle Architects ABN 83 006 814 268

Client **University of Melbourne Parkville Campus**  
 Project **Faculty of Architecture Building and Planning**

Title **CEILING JUNCTION DETAILS**

Project No. <b>0913</b>	Scale 1:5 @ A0 1:10 @ A2
Drawing No. <b>AR 7850</b>	

Date: Dec 2011 Drawn: Co-Ord: Chk:

FILENAME - SFILES

**FOR CONSTRUCTION**